



PSSMGMT Navigation Help

The online application www.pssmgmt.de has been developed as part of the EU-funded project PsyCris. Its primary purpose is to make recommendations for psychosocial support specifically addressing aspects relevant for the disaster management.

Please note: The individual recommendations do not appear in any particular order.

Each phase or sub-section can be read independently of each other, which means that certain aspects may be repeated, whereas others may be modified or changed.

How to navigate the *pssmgmt* online application

View of landing page

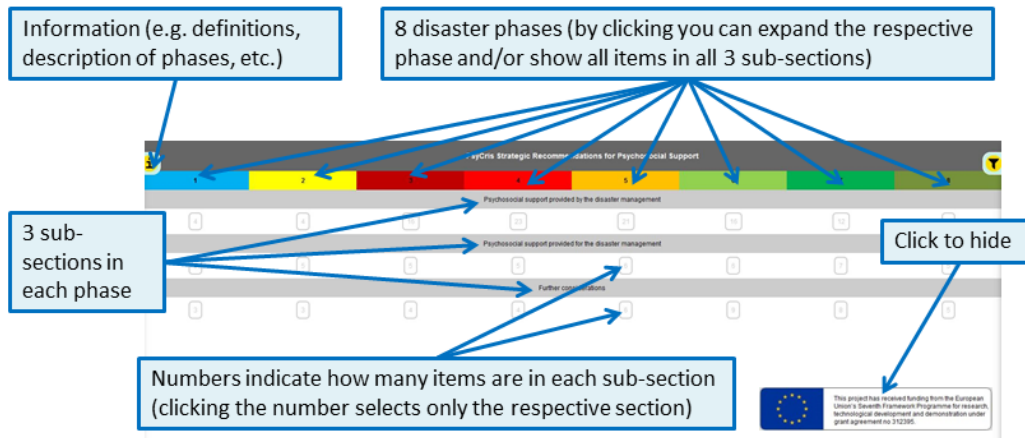

View of page with expanded phase

